

Terminal Unit



Specifications:

HTM 2022:1997/HTM 02-01 – Medical Gas Pipeline system

C11 – NHS Estates Model Engineering Specification

EN737-3: 1998 – Medical Gas Pipeline System

BS 5682:1984 : Terminal units, hose assemblies and their connections for use with medical gas pipeline system

Introduction

Terminal units are points on a medical gas pipeline system where the operator makes connections and disconnections for the supply of specific medical gases.

The single terminal unit consists of one first fix and one second fix assembly and it also comes with boxes suitable for flush and surface mounted applications. Depend on the specific gas the terminal units are intended for use with oxygen, nitrous oxide, compressed air, vacuum and with compressed air for driving of surgical tools.

Description

WTK terminal units are tested in accordance to the latest EN standards and passed the most stringent test, i.e. 10,000 cycles durability test along with many other tests required by this standard.

The first fix consists of a terminal block with shut off valve and a stub of 12mm copper pipe and a blank plate. The second fix consists of the fascia assembly, valve connection assembly and mounting box (come with bezel for flush assembly).

The identifications of gases are clearly indexed in the first fix and second fix and the terminal units are designed in such a way to protect the non-interchangeability for various gases.

All the components are degreased and packed in order to maintain the highest standards of hygiene and each unit is pressure tested before dispatch.

TECHNICAL SPECIFICATION:

Designation	WT24000 Terminal Unit
Material	Aluminium & Steel base / ABS / Brass / Stainless Steel Pins
Finishing	Color coded with Gas Identification

Model Number:

Flush/Surface wall mounted TU	
WT24001	O2
WT24002	N2O
WT24003	O2/N2O
WT24004	MA4
WT24005	SA7
WT24006	VAC
WT24007	AGSS
Bedhead mounted TU	
WT24010	O2
WT24011	N2O
WT24012	O2/N2O
WT24013	MA4
WT24014	SA7
WT24015	VAC
WT24016	AGSS
Pendant mounted TU	
WT24020	O2
WT24021	N2O
WT24022	O2/N2O
WT24023	MA4
WT24024	SA7
WT24025	VAC
WT24026	AGSS

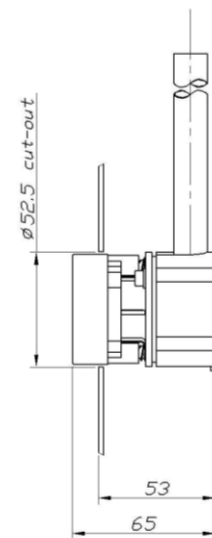
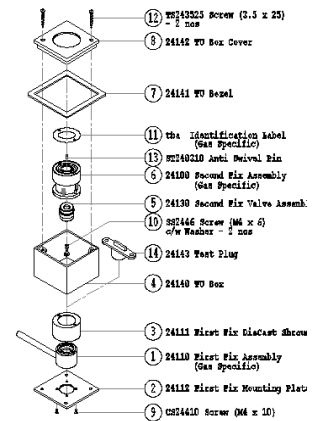

Wall Mounted TU



Bed Head Mounted TU



Pendant Mounted TU

TÜV Rheinland certified company for ISO 13485 & CE0197 Marking

